



Model SP3A Grain Spreader List Prices

Description	Maximum Hatch Bracket span		Part Number	List Price	Weight	
	inches	cm			lb	kg
SP3A Spreader with ½ hp (0.37 kW) Motor	40"	101.6	032135	\$830	86	39
SP3 Spreader without Motor	40"	101.6	032109	\$648	59	27
SP3A Plus Spreader with 1 hp (0.75 kW) Motor	40"	101.6	032156	\$916	91	41
SP3A Plus Spreader without Motor	40"	101.6	032173	\$684	59	27
SP3A ½ hp (0.37 kW) 3-phase 460V (without cord/plug)	40"	101.6	032162	\$994	86	39

Price Includes

- SP3A Main Unit
- SP3, ½ or 1 hp (0.37 or 0.75 kW) Motor (with motor only)
- Pulleys and A51 V-Belt
- Belt Guard
- Motor Guard
- Motor Mount
- Hatch Brackets
- Spreader Hanger Straps
- Spreader Pans with Fins and Covers Mounted
- Pan Adjusting Tool

The motor pulley supplied on SP3A units is a Two-Step Pulley. The small step is to be used on bins 30' in diameter and smaller. The large step is to be used on bins over 30' in diameter.

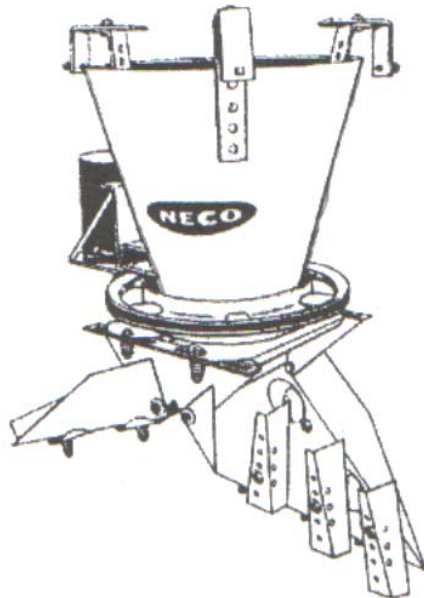

Spreader Capacity* Bushels per Hour (BPH)		
Bin Diameter	SP3A	Plus
15'	3000	3500
21'	3000	3500
24'	2900	3500
30'	2800	3500
36'	2500	3500
42'	2000	3500
48'	1600	3500

*Rated for dry corn.

Manufactured by



Division of GLOBAL Industries, Inc.
9364 North 45th Street
Omaha, Nebraska 68152
www.necousa.com



Model SP4 and SP4S Grain Spreaders

•SP4 (Long spreader Pan)

•SP4S (Short spreader Pan)

Description	Maximum Hatch Bracket span		Part Number	List Price	Weight	
	inches	cm			lb	kg
Model SP4 (spreads Bin Diameter 37' to 60')	50"	50"	032105	\$1,470	170	77
Model SP4S (spreads Bin Diameter 36' and less)	50"	50"	032106	\$1,470	168	76
Hatch Bracket Extension Kit	71"	71"	032108	\$128	10	5
Centering Funnel (Centers grain in spreader funnel)			032190	\$145	10	5
Model SP4 with Extra Long Brackets (37' to 60')	72"	72"	032192	\$1,507	175	79
Model SP4S with Extra Long Brackets (bin diameter 36' & less)	72"	72"	032193	\$1,507	173	78

SP4 and SP4S Include

- Spreader Funnel
- Flow Control
- Gates
- Spreader Pans
- V-Belts B x 65 (036154)
- Driven Pulley
- Motor Mount
- Hanger Brackets
- Pan Adjusting Tool
- Grain Deflectors

Not Included

- 1725 to 1800 RPM Motor (56, 182T,184T,145T, or 143T Frames)
- Motor Pulley (See Requirements)

Motor Power Requirements

Capacity: Dry Corn Bushels per Hour	Bin Diameters											
	30'		36'		42'		48'		54'		60'	
	hp	kW	hp	kW	hp	kW	hp	kW	hp	kW	hp	kW
3000	¾	0.56	¾	0.56	1	0.75	1½	1.12	1½	1.12	2	1.49
4000	¾	0.56	1	0.75	1½	1.12	1½	1.12	2	1.49	2	1.49
5000	¾	0.56	1	0.75	1½	1.12	2	1.49	2	1.49	N/A	N/A
5400	1	0.75	1½	1.12	1½	1.12	2	1.49	N/A	N/A	N/A	N/A

N/A= Not Applicable

Motor Pulley Requirements

Description	Part Number	List Price	Weight lb	Weight kg
47'-and-Smaller Diameter Bins				
•2" (5.08cm) OD, 1.7" (4.318cm) Pitch Diameter, "A"2-Groove, 5/8" (1.587cm) Bore	036214	\$34	2	1
•2" (5.08cm) OD, 1.7" (4.318cm) Pitch Diameter, "A" 2-Groove, 7/8" (2.222cm) Bore	036215	\$36	2	1
48'-to-60' Diameter Bins				
•2.2" (5.588cm) Pitch Diameter, "A" 2-Groove, 7/8" (2.222cm) Bore	035878	\$38	2	1
•2.2" (5.588cm) Pitch Diameter, "A" 2-Groove, 1 1/8" (2.857cm) Bore	035988	\$52	2	1
New "B" for BX Belts				
•2.3 (5.842cm) Pitch Diameter, "B" 2-Groove, 5/8" (1.587cm) Bore	036236	\$37	2	1
•2.3 (5.842cm) Pitch Diameter, "B" 2-Groove, 7/8" (2.222cm) Bore	032226	\$37	2	1
•2.6 (5.842cm) Pitch Diameter, "B" 2-Groove, 1 1/8" (2.857cm) Bore	032227	\$42	2	1



Model SP5 Grain Spreader List Prices

Description	Maximum Hatch Bracket span		Part Number	List Price
	inches	cm		
SP5 Spreader (for bin diameters 37' to 60')	50"	127	032250	\$1481
Hatch Bracket extension Kit	72"	182.9	032108	\$128

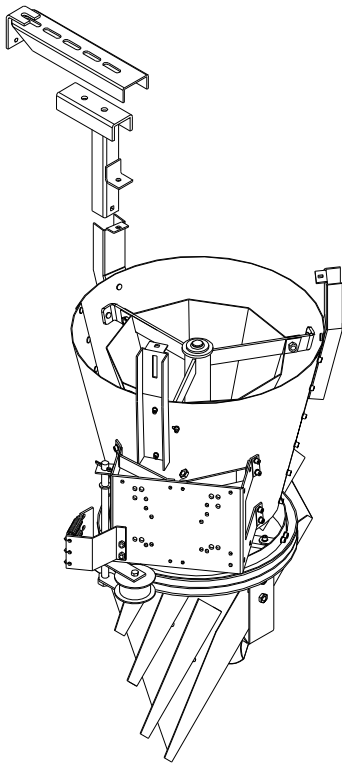

Price Includes

- SP5 Main Unit
- Driven Pulleys
- 032222 Belt BX68 Notched
- Belt Guard
- Motor Guard
- Motor Mount
- Hatch Brackets
- Spreader Hanger Straps
- Spreader Pans with Fins and Covers Mounted
- Pan Adjusting Tool
- Easy Adjustable Spreader Pan

Not included

- Motor - To order, Please see page EM-1 under Motors and Gear Boxes.
- Motor Pulley - See chart below.

Motor Power Requirements

Capacity: Dry Corn Bushels per Hour	Power Required hp kW		Type of 2-Groove Pulley Required					
			Bore Diameter inches	cm	Pulley Diameter inches	cm	Part Number	List Price*
5000-6000	2	1.49	7/8"	2.222	2.3"	5.842	032226	\$37
7000-10000	3	2.24	1 1/8"	2.857	2.6"	6.604	032227	\$42

Manufactured by



Division of GLOBAL Industries, Inc.
9364 North 45th Street
Omaha, Nebraska 68152
www.necousa.com



Conversion Table				
Length Conversion ' = foot or feet " = inch or inches ¼" = 0.635 cm ½" = 1.27 cm ¾" = 1.905 cm 1" = 2.54 cm 1¼" = 3.175 cm 1½" = 3.81 cm 1¾" = 4.445 cm 2" = 5.08 cm 3" = 7.62 cm 3.2" = 8.128 cm 4" = 10.16 cm 5" = 12.7 cm 6" = 15.24 cm 7" = 17.78 cm 7½" = 19.05 cm 8" = 20.32 cm 9" = 22.86 cm 10" = 25.40 cm 11" = 27.94 cm 12" = 30.48 cm 13" = 33.02 cm 14" = 35.56 cm 15" = 38.10 cm 16" = 40.64 cm 18" = 45.72 cm 18.4" = 46.74 cm 20" = 50.8 cm 22" = 55.88 cm 24" = 60.96 cm 27" = 68.58 cm 28" = 71.12 cm 30" = 76.2 cm 30½" = 77.47 cm 32" = 81.28 cm 33" = 83.82 cm 36" = 91.44 cm 43" = 109.2 cm 52" = 132.1 cm 63" = 160 cm	1' = 0.3048 meters 2' = 0.6096 meters 3' = 0.9144 meters 4' = 1.219 meters 4'8" = 1.422 meters 5' = 1.524 meters 6' = 1.829 meters 7' = 2.134 meters 7'6" = 2.286 meters 8' = 2.438 meters 9' = 2.743 meters 10' = 3.048 meters 11' = 3.353 meters 12' = 3.658 meters 13' = 3.962 meters 14' = 4.267 meters 15' = 4.572 meters 16' = 4.877 meters 17' = 5.182 meters 18' = 5.486 meters 19' = 5.791 meters 20' = 6.096 meters 21' = 6.401 meters 22' = 6.706 meters 23' = 7.01 meters 24' = 7.315 meters 25' = 7.62 meters 26' = 7.925 meters 27' = 8.23 meters 28' = 8.534 meters 29' = 8.839 meters 30' = 9.144 meters 31' = 9.449 meters 32' = 9.754 meters 33' = 10.06 meters 34' = 10.36 meters 35' = 10.67 meters 36' = 10.97 meters 37' = 11.28 meters 38' = 11.58 meters 39' = 11.89 meters	40' = 12.19 meters 41' = 12.5 meters 42' = 12.8 meters 43' = 13.11 meters 44' = 13.41 meters 45' = 13.72 meters 46' = 14.02 meters 47' = 14.33 meters 48' = 14.63 meters 49' = 14.94 meters 50' = 15.24 meters 51' = 15.54 meters 52' = 15.85 meters 53' = 16.15 meters 54' = 16.46 meters 55' = 16.76 meters 56' = 17.07 meters 57' = 17.37 meters 58' = 17.68 meters 59' = 17.98 meters 60' = 18.29 meters 61' = 18.59 meters 62' = 18.9 meters 63' = 19.2 meters 64' = 19.51 meters 65' = 19.81 meters 66' = 20.12 meters 67' = 20.42 meters 68' = 20.73 meters 69' = 21.03 meters 70' = 21.34 meters 71' = 21.64 meters 72' = 21.95 meters 73' = 22.25 meters 74' = 22.56 meters 75' = 22.86 meters 76' = 23.16 meters 77' = 23.47 meters 78' = 23.77 meters 79' = 24.08 meters	80' = 24.38 meters 81' = 24.69 meters 82' = 24.99 meters 83' = 25.3 meters 84' = 25.6 meters 85' = 25.91 meters 86' = 26.21 meters 87' = 26.52 meters 88' = 26.82 meters 89' = 27.13 meters 90' = 27.43 meters 91' = 27.74 meters 92' = 28.04 meters 93' = 28.25 meters 94' = 28.65 meters 95' = 28.96 meters 96' = 29.26 meters 97' = 29.57 meters 98' = 29.87 meters 99' = 30.18 meters 100' = 30.48 meters 101' = 30.78 meters 102' = 31.09 meters 103' = 31.39 meters 104' = 31.7 meters 105' = 32 meters 106' = 32.31 meters 107' = 32.61 meters 108' = 32.92 meters 109' = 33.22 meters 110' = 33.53 meters 111' = 33.83 meters 112' = 34.14 meters 113' = 34.44 meters 114' = 34.75 meters 115' = 35.05 meters 116' = 35.36 meters 117' = 35.66 meters 118' = 35.97 meters 119' = 36.27 meters	120' = 36.58 meters 121' = 36.88 meters 122' = 37.19 meters 123' = 37.49 meters 124' = 37.8 meters 125' = 38.1 meters 126' = 38.4 meters 127' = 38.71 meters 128' = 39.01 meters 129' = 39.32 meters

Conversion Factors			
Abbreviations ' = foot or feet " = inch or inches lb = pound kg = kilogram cm = centimeter m = meter hp = horsepower kW = kilowatt hz = hertz	Distance and Length centimeter x 0.394 = inches centimeter x 0.03281 = feet meter x 3.281 = feet inches x 2.540 = centimeters feet x 30.48 = centimeters feet x 0.3049 = meters	Weight and Mass pounds x 0.454 = kilogram kilogram x 2.205 = pounds	Power horsepower x 0.746 = kilowatts kilowatts x 1.34 = horsepower